

## Tubing System from Dustcontrol

The tubing system transports the material from the point of collection to the central unit. Dust is generally abrasive, some more than others, therefore the standard material thickness of the tubing system is 1,5 mm. Applications with fume and light dust use reinforced spiral duct. Stainless tubing systems and extra abrasion resistant fittings are available.

Dustcontrol has a very comprehensive assortment of tubing fittings and installation hardware. This gives greater flexibility in design and installation of our tubing systems. Our mechanical jointing system makes alterations and additions very easy to implement.

## Elastomer Tubing System

An effective tubing system has to meet certain requirements. Constant transport velocity in the tubing at different loads is one requirement. Correct transport velocity is another. When the velocity is too low, the material will cause a blockage. When the velocity is too high, this will lead to unnecessary wear and loss of energy. Dustcontrol's competent staff can dimension a system to your needs.

When transporting material in a tubing system turbulent flow will cause noise. Material particles impact the hard tubing walls. Using an elastomer (EPDM- and NBR-rubber) in bends, branch pipes and mounting brackets moderates the sound considerably.

Bends and branch pipes are designed to withstand high negative pressure. The bends are designed with a radial ridge to spread the impact area of the material thereby reducing wear and minimizing the risk of blockage.

Every elastomer bend and branch pipe are designed with a plugged hole, that can be used for measuring and inspection.

The advantages with the elastomer tubing system are:

- Low noise
- Blockage risk reduced
- Reduced wear

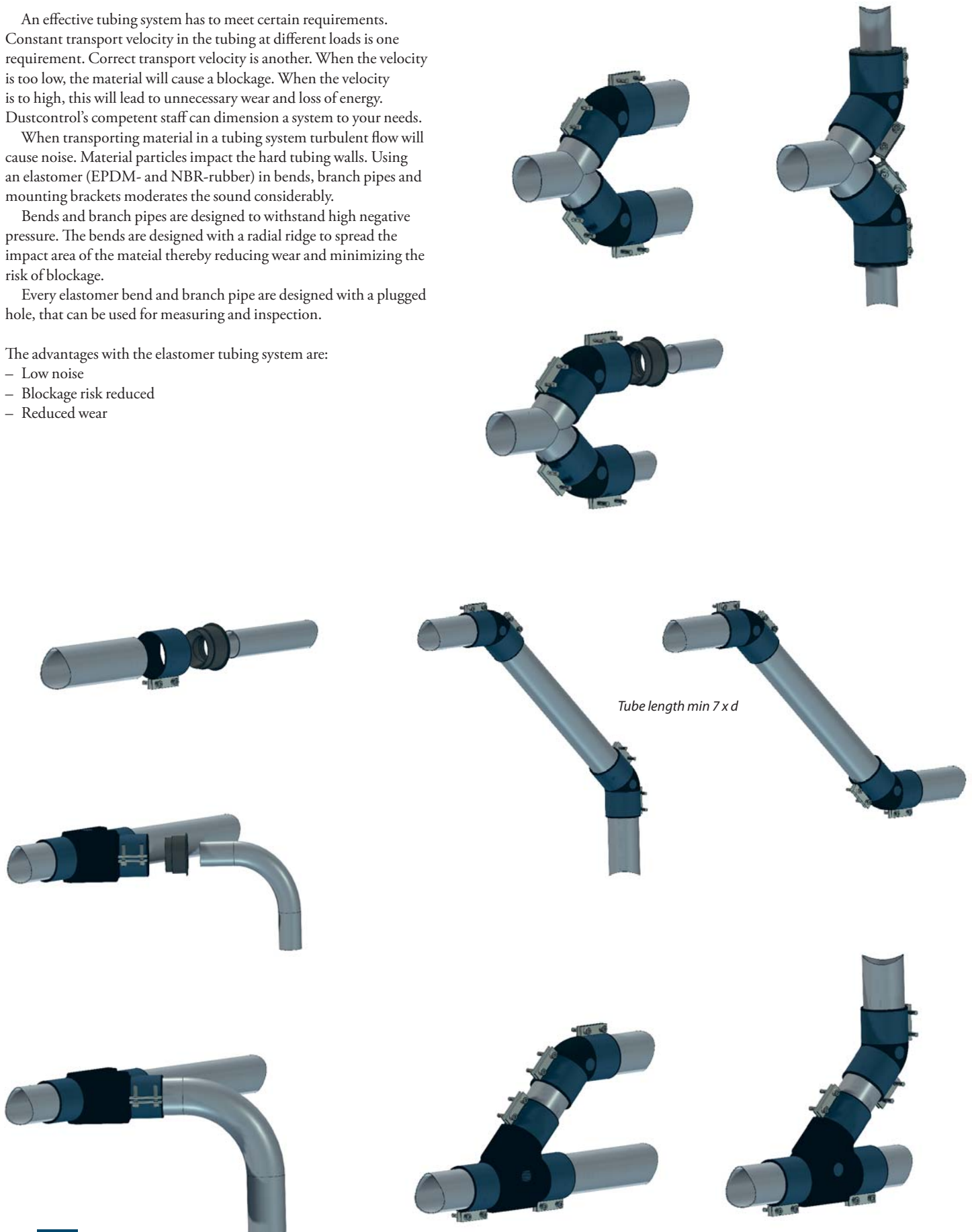

## Tubing System Details

Cones, branch pipes and bends are manufactured in EPDM- and NBR- rubber. The components are abrasion resistant and sound absorbing.

### Steel Tubing

Our standard tubing system is of zinc coated carbon steel tubing and is used on 90 % of all Dustcontrol installations. Heavy wall thickness results in long life even in installations where considerable abrasion is present.

### Stainless Steel Tubing

Stainless tubing is used with abrasive materials or because of hygienic considerations. When installed in material transportation, long radius bends should be used.

### Reinforced Spiro Tubing

Spiro tubing is used most commonly for the connection of the central unit components, vacuum producer, filter unit and pre-separator. Spiro is not generally suitable for application with coarse and abrasive material but is commonly used in extraction systems for vapour, fume and light dust.

### Mounting Hardware

Dustcontrol has a complete range of mounting hardware facilitating straightforward installation as well as changes.

Transport of	Air Flow	Tube Dimension	
dust, coarse and heavy material	(100–260 m <sup>3</sup> /h)	Ø 50 <sup>*)</sup>	
	300–600 m <sup>3</sup> /h	Ø 76	
	600–1200 m <sup>3</sup> /h	Ø 108	
	1200–2600 m <sup>3</sup> /h	Ø 159	
fume, vapour and clean air	180–320 m <sup>3</sup> /h	Ø 76	Steel Tubing
	320–550 m <sup>3</sup> /h	Ø 100	Reinforced
			Spiral Tubing
	370–620 m <sup>3</sup> /h	Ø 108	Steel Tubing
	510–850 m <sup>3</sup> /h	Ø 125	Reinforced
			Spiral Tubing
	840–1400 m <sup>3</sup> /h	Ø 159/Ø 160	Steel Tubing/ Reinforced Spiral Tubing
	1300–2200 m <sup>3</sup> /h	Ø 200	Reinforced Spiral Tubing
	2100–3500 m <sup>3</sup> /h	Ø 250	Reinforced Spiral Tubing

<sup>\*)</sup> on most systems, 76 mm should be selected as the smallest tube diameter. Only systems where a small air-flow is desired or installation is more easily facilitated should 50 mm be used.

Installation Example

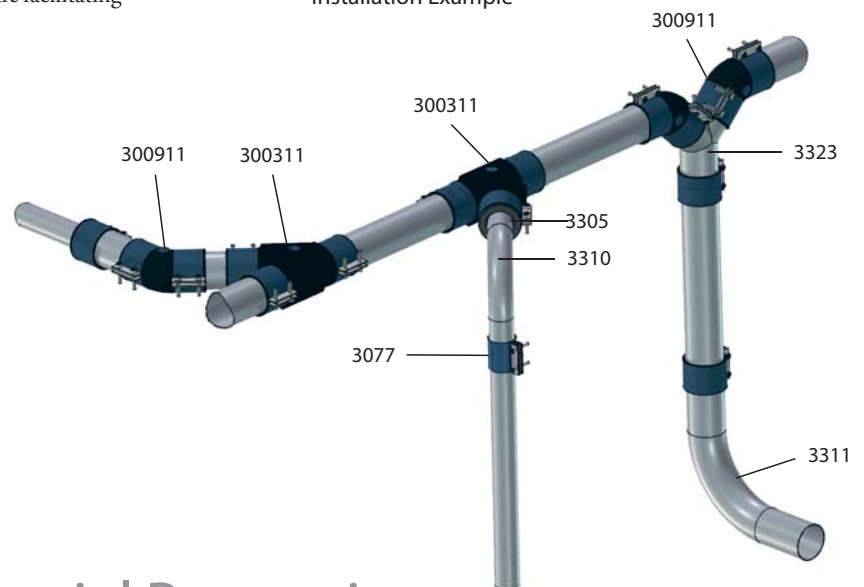

## Tubing System Material Properties

TECHNICAL DATA	EPDM (Blue)	NBR (Grey)
Temp °C max/min	140/–60	120/–60
Antistatic*	Yes	Yes
Abrasion resistance	Very Good	Good
UV and Ozone resistance	Very Good	Limited
Resistance to fumes	Very Good	Good
Resistance to solvent and oil	Poor	Very good

\*Antistatic is defined as having a conductivity of < 10<sup>6</sup> Ω

The measurements are in millimeter if nothing else is given.

## Tubing

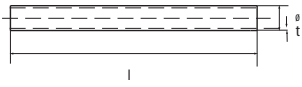

Part No	Desc.	Material	Ø	l(m)	t	m (kg/m)
3071	Ø50	Steel <sup>1</sup>	50.8	3	1.5	1.82
3340**	Ø50	Steel <sup>1</sup>	50.8	0.135	1.5	1.82
3211	Ø50	Stainless <sup>2</sup>	50.8	3	1	1.3
3004	Ø76*	Steel <sup>1</sup>	76	3	1.5	2.58
3341**	Ø76	Steel <sup>1</sup>	76	0.135	1.5	2.58
3212	Ø76	Stainless <sup>2</sup>	76	3	1	1.9
3039	Ø108*	Steel <sup>1</sup>	108	3	1.5	3.94
3342**	Ø108	Steel <sup>1</sup>	108	0.135	1.5	3.94
3267	Ø108	Stainless <sup>2</sup>	108	3	2	5.2
3227	Ø159	Stainless <sup>2</sup>	159	3	1	4.0
3060	Ø159	Steel	159	3	2	7.74

\* Full handle of 6 m lengths, totally 114 m: Part No 3278, Ø76\*, Part No 3279, Ø108\*

\*\* Tube stub required when mounting a 45 bend directly to a branch pipe.

## Bend 90°

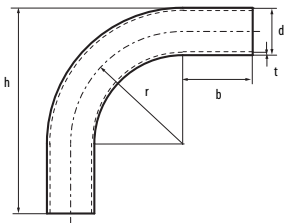

Part No	Desc.	Material	Ø	r	b	t	h	m(kg)
3310	bend Ø 50	Steel <sup>1</sup>	50.8	120	75	1.5	220	0.6
3314	bend Ø 50	Stainless <sup>2</sup>	50.8	120	75	1.5	220	0.6
3309	bend Ø 50	Steel <sup>1</sup>	50.8	85	75	1.5	185	0.3
3117 <sup>6</sup>	bend Ø 50	Steel <sup>1</sup>	50.8	50	–	1.5	115	0.3
3118 <sup>6</sup>	bend Ø 76	Steel <sup>1</sup>	76	65	–	1.5	150	0.55
3311	bend Ø 76	Steel <sup>1</sup>	76	160	115	1.5	313	1.3
3316	bend Ø 76	Stainless <sup>2</sup>	76	160	115	1.5	313	1.3
3319	bend Ø 108	Steel <sup>1</sup>	108	160	165	2.0	380	3.0
3320	bend Ø 108	Stainless <sup>2</sup>	108	160	165	2.0	380	3.0
3262	bend Ø 159	Stainless <sup>2</sup>	159	87	90	1.0	260	1.75
3043	bend Ø 159	Spiro <sup>5</sup>	159	160	–	1.0	160	0.8
3061	bend Ø 159	Steel <sup>1</sup>	159	375	0	4.5	455	10.1

## Bend 90°, extended

Part No	Desc.	Material	Ø	r	b	t	m(kg)
3169	Ø 76	Steel <sup>1</sup>	76	175	150	2.9	3.0
3266	Ø 76	Stainless <sup>2</sup>	76	460	–	2	3.2
3165	Ø 108	Steel <sup>1</sup>	108	250	150	3.6	6.5
3303	Ø 108	Stainless <sup>2</sup>	108	800	150	2	10
3161	Ø 159	Steel <sup>1</sup>	159	375	150	4.5	15.3

For other dimensions, please contact Dustcontrol.

## Bend 45°

(complete with joints)

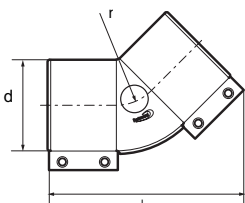

Part No	Desc.	Material	d	l	r	m(kg)	No of screws	Plate
307311	bend Ø 50	EPDM <sup>3</sup> blue	50.8	150	66	0.5	1	plastic
3343	bend Ø 50	EPDM <sup>3</sup> stainless	50.8	150	66	0.5	1	plastic
307312	bend Ø 50	NBR <sup>4</sup> blue	50.8	150	66	0.5	1	plastic
300911	bend Ø 76	EPDM <sup>3</sup> blue	76	170	79	0.6	2	steel
3344	bend Ø 76	EPDM <sup>3</sup> stainless	76	170	79	0.6	1	plastic
300912	bend Ø 76	NBR <sup>4</sup> blue	76	170	79	0.6	2	steel
302911	bend Ø 108	EPDM <sup>3</sup> blue	108	195	94	0.8	2	steel
3345	bend Ø 108	EPDM <sup>3</sup> stainless	108	195	94	0.8	2	stainless
302912	bend Ø 108	NBR <sup>4</sup> blue	108	195	94	0.8	2	steel

<sup>1</sup>Carbon Steel Zink Coated, 1311.

<sup>2</sup>Stainless steel SS2333/Grade 1.4301/DIN X 5 CrNi 1810/UNSS30400/AFNOR Z 6 CN 18.09/ANSI 304/BS 304S15.

<sup>3</sup>Rubber, EPDM.

<sup>4</sup>Rubber, NBR.

<sup>5</sup>Reinforced Spiral Tubing.

<sup>6</sup>Only for restricted spaces.

For information about material properties see page 108.

## Bend 45°

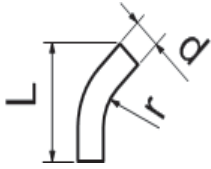

Part No	Desc.	Material	L (mm)	t (mm)	a (o)	r
3317	Ø 76	Steel <sup>1</sup>	333	1.5	45	160
3318	Ø 76	Stainless	333	1.5	45	160
3315	Ø 108	Stainless	433	2	45	160
3321	Ø 108	Steel <sup>1</sup>	433	2	45	160
3062	Ø 159	Steel <sup>1</sup>	166.5	4.5	45	375

## Cone

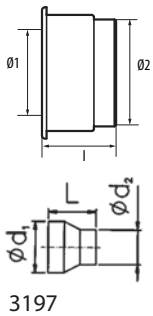

Part No	Desc.	Material	Ø1	Ø2	l	t	m(kg)
3305	Ø 76/50	EPDM <sup>3</sup>	50.8	76	50	–	0.14
3325	Ø 76/50	NBR <sup>4</sup>	50.8	76	50	–	0.14
3197	Ø 80/76	Steel <sup>1</sup>	76	80	70	2.0	0.15
3306	Ø 108/76	EPDM <sup>3</sup>	76	108	55	–	0.25
3326	Ø 108/76	NBR <sup>4</sup>	76	108	55	–	0.25
3327	Ø 108/100	NBR <sup>4</sup>	100	108	35	–	0.06
3307	Ø 108/100	EPDM <sup>3</sup>	100	108	35	–	0.06
3308	Ø 159/108	EPDM <sup>3</sup>	108	159	70	–	0.72
3328	Ø 159/108	NBR <sup>4</sup>	108	159	70	–	0.72

## Y-pipe

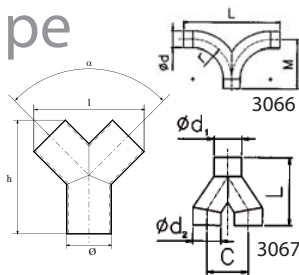

Part No	Desc.	Material	α	Ø	l	h	t	m(kg)
3324	Ø 50	Steel <sup>1</sup>	90°	50.8	150	175	1.5	0.42
3331	Ø 50	Stainless <sup>2</sup>	90°	50.8	150	175	1.5	0.42
3323	Ø 76	Steel <sup>1</sup>	90°	76	190	195	1.5	0.68
3330	Ø 76	Stainless <sup>2</sup>	90°	76	190	195	1.5	0.68
3322	Ø 108	Steel <sup>1</sup>	90°	108	235	225	2.0	1.4
3329	Ø 108	Stainless <sup>2</sup>	90°	108	235	225	2.0	1.4
3066	Ø 159	Steel <sup>1</sup>	180°	159	850	505	4.5	2.3
3067	Ø 159	Steel <sup>1</sup>	0°	159	850	458	2.0	6.0

## Joint

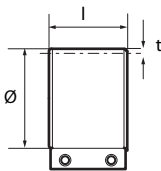

Part No	Desc.	Material	Ø	l	t	m(kg)	No of screws	Plate
3077	Ø 50	EPDM <sup>3</sup> blue	50.8	65	4.5	0.2	1	plastic
307702	Ø 50	EPDM <sup>3</sup> stainless	50.8	65	4.5	0.2	1	plastic
3271	Ø 50	NBR <sup>4</sup> blue	50.8	65	4.5	0.2	1	plastic
3007	Ø 76	EPDM <sup>3</sup> blue	76	65	5.0	0.3	2	steel
300702	Ø 76	EPDM <sup>3</sup> stainless	76	65	5.0	0.3	1	plastic
3272	Ø 76	NBR <sup>4</sup> blue	76	65	5.0	0.3	2	steel
3031	Ø 108	EPDM <sup>3</sup> blue	108	65	5.5	0.4	2	steel
303102	Ø 108	EPDM <sup>3</sup> stainless	108	65	5.5	0.4	2	stainless
3273	Ø 108	NBR <sup>4</sup> blue	108	65	5.5	0.4	2	steel
3045	Ø 159	EPDM <sup>3</sup> blue	159	65	6.5	0.5	2	steel
304502	Ø 159	EPDM <sup>3</sup> stainless	159	65	6.5	0.5	2	stainless
3274	Ø 159	NBR <sup>4</sup> blue	159	65	6.5	0.5	2	steel

<sup>1</sup> Carbon Steel Zink Coated, 1311.

<sup>2</sup> Stainless steel SS2333/Grade 1.4301/DIN X 5 CrNi 1810/UNSS30400/AFNOR Z 6 CN 18.09/ANSI 304/BS 304S15.

<sup>3</sup> Rubber, EPDM.

<sup>4</sup> Rubber, NBR.

<sup>5</sup> Reinforced Spiral Tubing.

For information about material properties see page 108.

## Branch pipe 45°

(complete with joints)

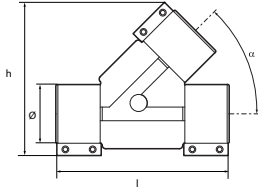

Part No	Desc.	Material	Ø	l	h	m(kg)	No of screws	Plate
307411	Ø 50	EPDM <sup>3</sup> blue	50.8	220	150	0.8	1	plastic
3346	Ø 50	EPDM <sup>3</sup> stainless	50.8	220	150	0.8	1	plastic
307412	Ø 50	NBR <sup>4</sup> blue	50.8	220	150	0.8	1	plastic
300311	Ø 76	EPDM <sup>3</sup> blue	76	250	200	1.2	2	steel
3347	Ø 76	EPDM <sup>3</sup> stainless	76	250	200	1.2	1	plastic
300312	Ø 76	NBR <sup>4</sup> blue	76	250	200	1.2	2	steel
303511	Ø 108	EPDM <sup>3</sup> blue	108	300	260	1.6	2	steel
3348	Ø 108	EPDM <sup>3</sup> stainless	108	300	260	1.6	2	stainless
303512	Ø 108	NBR <sup>4</sup> blue	108	300	260	1.6	2	steel

## Branch pipe

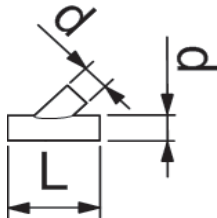

Part No	Desc	Material	L (mm)	t (mm)	a (o)
3003	Ø 76	Steel <sup>1</sup>	245	1.5	45
3199	Ø 76	Stainless	245	1.5	45
3357	Ø 108	Steel <sup>1</sup>	267	1.5	45
3358	Ø 108	Stainless	267	1.5	45
3063	Ø 159	Steel <sup>1</sup>	400	2.0	45

## Spiro Branch pipe

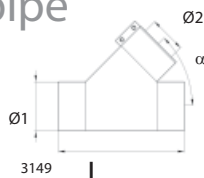

Part No	Desc.	Material	α	Ø 1	Ø 2	l	m (kg)
3149*	Ø 159/159	Spiro <sup>5</sup>	45°	159	159	370	2.5

\*For Ø 159/108 use 3308 cone and 3045 joint.

## Pressure Distributor box

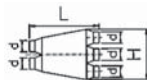

Part No	Desc.	Ø	L	H	B	m (kg)
3057	3/2	108	650	472	110	10
3058	2/2	108	550	315	110	7

## End cap for steel tubing



Part No	Desc.	Ø
3172	Ø 50	50.8
3174	Ø 76	76
3906	Ø 108	108

<sup>1</sup> Carbon Steel Zink Coated, 1311.

<sup>2</sup> Stainless steel SS2333/Grade 1.4301/DIN X 5 CrNi 1810/UNSS30400/AFNOR Z 6 CN 18.09/ANSI 304/BS 304S15.

<sup>3</sup> Rubber, EPDM.

<sup>4</sup> Rubber, NBR.

<sup>5</sup> Reinforced Spiral Tubing.

For information about material properties see page 108.

# Abrasion Resistant Bend

## Abrasion Resistant Bend 90°

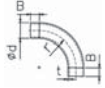

## Joint Abrasion Resistant Bend

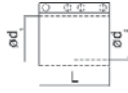

Part No	Desc.	$\phi d$ (mm)	$r$ (mm)	B (mm)	$t$ (mm)	$m$ (kg)
3235	$\phi 76$	87	175	50	7.0	5.0
3234	$\phi 108$	121	250	50	5.5	10.6

Part No	Desc.	$\phi d_1$ (mm)	$\phi d_2$ (mm)	L	$m$ (kg)
3243	$\phi 76$	87	76	130	0.50
3244	$\phi 108$	121	108	130	0.70

# Reinforced Spiro Tubing

## Spiro Tubing

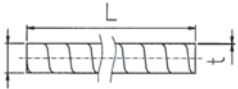

Part No/m	$d$ (mm)	$A$ (m <sup>2</sup> )	$t$ (mm)	L (mm)	$m$ (kg/m)
3013	100	0.008	0.6	3	1.8
3123	125	0.012	0.6	3	2.2
3042	160	0.020	0.8	3	3.7
3095	200	0.031	0.8	3	4.7
3090	250	0.049	0.8	3	5.9

## Bend 90°

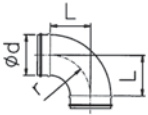

Part No	$d$ (mm)	L (mm)	$r$ (mm)	$m$ (kg)
3014	100	100	100	0.4
3124	125	125	125	0.6
3043	160	160	160	0.8
3096	200	200	200	1.5
3091	250	250	250	2.4

## Bend 45° Spiro

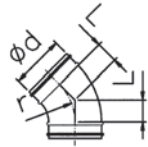

Part No	$d$ (mm)	L (mm)	$r$ (mm)	$m$ (kg)
3086	100	43	100	0.3
3125	125	52	125	0.4
3089	160	66	160	0.6
3088	200	83	200	0.9
3087	250	104	250	1.3

## Bend 30°



Part No	$d$ (mm)	L (mm)	$r$ (mm)	$m$ (kg)
3024	100	28	100	0.3
3126	125	33	125	0.3
3025	160	43	160	0.5
3026	200	54	200	0.7
3027	250	67	250	1.4

## Y-pipe

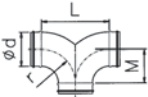

Part No	$d$ (mm)	L (mm)	M (mm)	$r$ (mm)	$m$ (kg)
3127	125	375	190	190	1.5
3128	160	480	240	240	2.5
3129	200	600	300	300	3.8
3130	250	750	375	375	8.6

## Branch Pipe

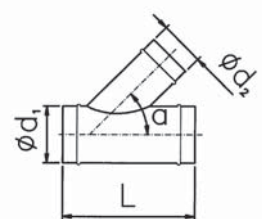

Part No	Desc.	$d_1$ (mm)	$d_2$ (mm)	L (mm)	$a$ (°)	$m$ (kg)
3131	100/100	100	100	290	45	1.3
3132	125/100	125	100	290	45	1.4
3148	125/125	125	125	290	45	1.6
3133	160/100	160	100	370	45	1.6
3134	160/125	160	125	370	45	1.9
3149	160/160	160	160	370	45	2.5
3135	200/100	200	100	460	45	2.2
3136	200/125	200	125	460	45	2.3
3137	200/160	200	160	460	45	2.9
3150	200/200	200	200	460	45	3.5
3138	250/160	250	160	575	45	3.4
3139	250/200	250	200	575	45	4.0
3151	250/250	250	250	575	45	4.6

## T-pipe

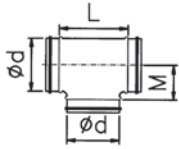

Part No	Bet	Ø d (mm)	L (mm)	M (mm)	m(kg)
3051	Ø 160	160	229	105	0.91

## Cone

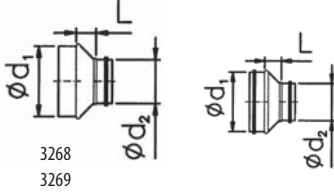

Part No	d <sub>1</sub> (mm)	d <sub>2</sub> (mm)	L (mm)	m (kg)
3054	100	80	18	0.2
3141	125	100	22	0.2
3157	125	110	48	0.3
3028	160	100	37	0.3
3142	160	125	26	0.2
3098	200	160	26	0.3
3093	250	200	32	0.6
3122	250	160	53	0.5
3268	250	160	113	0.6
3269	250	200	92	0.6

## Socket

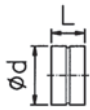

Part No	d (mm)	L (mm)	m (kg)
3055	100	90	0.1
3143	125	90	0.2
3056	160	90	0.2
3082	200	90	0.3
3083	250	130	0.5

## Nipple



Part No	d (mm)	m (kg)
3015	100	0.1
3144	125	0.2
3044	160	0.2
3099	200	0.3
3094	250	0.5

## Clean out Cover



Part No	Ø d (mm)	L (mm)	m (kg)
3152	100	40	0.1
3153	125	40	0.1
3154	160	40	0.2
3155	200	40	0.3
3156	250	40	0.5

## Inline Silencer

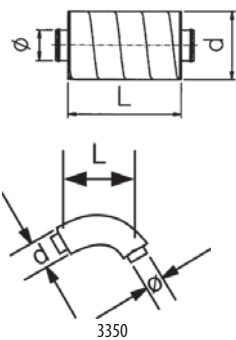

Part No	Ø (mm)	L (mm)	d (mm)	m (kg)
3182	160	1200	355	19.8
3183	160	600	355	10.7
3184	160	600	260	6.3
3228	125	300	224	3.0
4476	100	600	200	4.8
4942	100	300	200	2.6
3350	100	250	150	0.4
3195	80	300	180	2.2

### TECHNICAL DATA Silencers

Absorption dB for mean frequency Hz

Part No.	125	250	500	1k	2k	4k	8k
3182	10	18	34	49	53	30	18
3183	8	15	23	31	40	22	16
3184	4	8	21	37	40	22	14
3195	4	8	16	27	34	35	19
3228	2	7	14	21	26	20	12
4476	8	13	25	40	50	40	21
4942	4	8	14	23	27	25	14
3350	21	31	27	24	20	9	7

## Pressure Loss Tubing

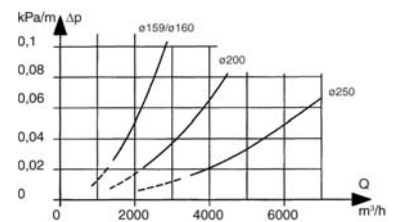
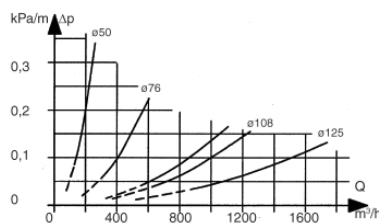

# Mounting Hardware

<b>1</b> Bracket		<b>Part No</b>	<b>Desc.</b>	<b>L (mm)</b>	<b>t (mm)</b>	<b>m (kg)</b>		
		3008	300	300	3	0.85		
		3037	500	500	3	1.5		
		3178	1000	1000	3	3.0		
<b>2</b> Clamping Band		<b>Part No</b>	<b>Desc.</b>	<b>d (mm)</b>	<b>L (mm)</b>	<b>m (kg)</b>		
		3107	50	51	140	0.10		
		3021	76	76	210	0.10		
		3022	110	108	290	0.10		
		3023	160	159	425	0.15		
<b>3</b> Wall- and Ceiling attachment		<b>Part No</b>	<b>Desc.</b>	<b>L (mm)</b>	<b>t (mm)</b>	<b>m (kg)</b>		
		3106	270	270	3	0.40		
		9622	2000	2000	3	3		
<b>4</b> Beam Clamp		<b>Part No</b>	<b>Desc.</b>	<b>M</b>				
		3192	M8	M8				
		3251	M10	M10				
<b>5</b> Threaded Rod		<b>Part No</b>	<b>Desc.</b>	<b>L (mm)</b>	<b>M</b>	<b>m (kg/m)</b>		
		3017	HGS8	2000	M8	0.35		
		3250	M10	1000	M10	0.50		
<b>6</b> Clamping Wrapper		* 5 pcs	<b>Part No*</b>	<b>d (mm)</b>	<b>B (mm)</b>	<b>t (mm)</b>	<b>m (kg)</b>	
			3185	50	20	1.25	0.10	
			3186	76	20	2.0	0.15	
			3187	110	25	2.0	0.25	
			3188	160	25	3.0	0.40	
			3189	200	25	3.0	0.55	
			3190	250	25	3.0	0.75	
			<b>Part No</b>	<b>d (mm)</b>	<b>B (mm)</b>	<b>t (mm)</b>		
			3245	50	24	1.5		
			3246	76	24	1.5		
	3284	101	24	2.0				
	3247	108	24	1.5				
	3248	160	24	2.0				
	3285	125	24	2.0				
	3249	200	24	3.0				
	3286	245	30	3.0				
<b>7</b> Tube Hanger EPDM Rubber Lined		<b>Part No</b>	<b>L (m)</b>	<b>b (mm)</b>	<b>t (mm)</b>	<b>m (kg/m)</b>		
		3158	25	25	1	0.15		
		<b>9</b> Part No	<b>L (mm)</b>	<b>b (mm)</b>	<b>h (mm)</b>			
			3159	300	41	21		
			3241	2000	41	21		perforated
			3252	3000	41	21		perforated
		<b>10</b> Part No	<b>a(mm)</b>	<b>b(mm)</b>	<b>t(mm)</b>			
			3253	52.6	45.5	5.0		
		<b>11</b> Part No	<b>M</b>					
			9601	M8				
	3289	M10						
<b>8</b> Pipe Strap		<b>Part No</b>	<b>L (m)</b>	<b>b (mm)</b>	<b>t (mm)</b>	<b>m (kg/m)</b>		
		3158	25	25	1	0.15		
<b>9</b> Adjusting Track		<b>Part No</b>	<b>L (mm)</b>	<b>b (mm)</b>	<b>h (mm)</b>			
		3159	300	41	21			
		3241	2000	41	21		perforated	
		3252	3000	41	21		perforated	
<b>10</b> Plate		<b>Part No</b>	<b>a(mm)</b>	<b>b(mm)</b>	<b>t(mm)</b>			
		3253	52.6	45.5	5.0			
<b>11</b> Spring Nut		<b>Part No</b>	<b>M</b>					
		9601	M8					
	3289	M10						
Two Part Clamp		<b>Part No</b>	<b>d</b>					
		3068	ø 160					
	3069	ø 200						
Z Attachment		<b>Part No</b>						
L Attachment		<b>Part No</b>						
Tie-Wrap, Nylon		<b>Part No</b>	<b>L (mm)</b>					
		9817	136					
		9815	360					
Duct Tape, Roll		<b>Part No</b>	<b>L (m)</b>					
		9076	50					
Fastener Set for Mounting		<b>Part No</b>						
		3198						

## New Wall- and Ceiling Attachment!

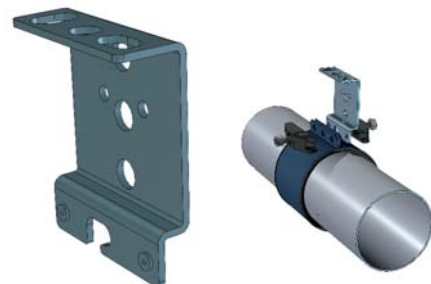

Wall- and Ceiling attachment Part No 42437

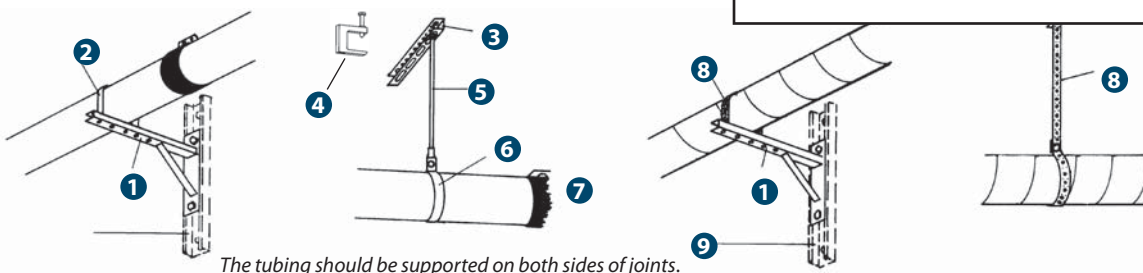

The tubing should be supported on both sides of joints.

# Cutter 108

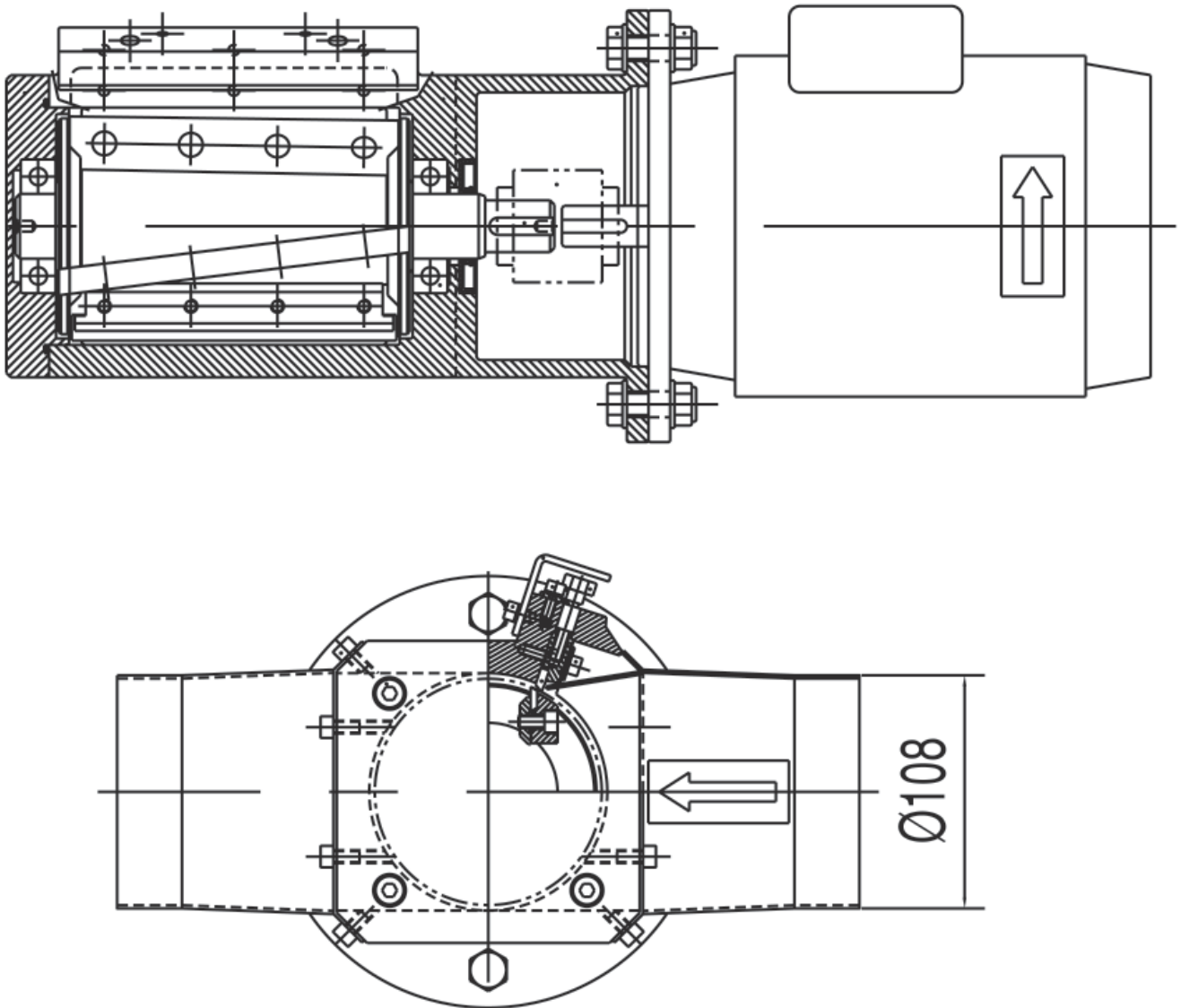

Cutter 108 has been developed for cutting plastic, paper and cardboardstrips and similar materials. The unit is connected to a f108 tubing system and will cut all material in the transport flow into 2–15 cm sized pieces. A rotor with three knives work against one stationary knife.

The knives should be serviced at least twice a year at normal operation 8 hours a day. Depending on amount and type of material the knives should be sharpened and adjusted (500–5000 operation hours).

The tubing system before and after the Cutter should consist of straight pipes. Because of safety reasons the inlet and outlet pipes should each be at least one metre long. At installation and service the safety considerations should always be followed.

*Part No 7357*

*Exchange rotor Cutter 108 Part No 40677*

## TECHNICAL DATA

Weight	19 kg	
In-/outlet	Ø108	
Motor power	0.75 kW	
Rotation speed	50 Hz	60 Hz
	2800 rpm	3400 rpm
Voltage	220–240/	254–277/
	360–415	440–480

## Flap Valves

For removable connection of the suction hose to the tubing system. The spring loaded flap is opened manually and the hose cuff is inserted into the valve body. On systems with on demand start-stop, the flap valve should be equipped with a micro-switch. This will give a start-stop signal for vacuum producer control.



Flap valve 50/76 with microswitch.

$d_{max}/D$	A		Microswitch	Part No
38/50 mm	X38		No	3232
38/50 mm	X38		Yes	8454
50/50 mm	X50		No	3070
50/50 mm	X50		Yes	8433
50/76 mm	X50		No	3006
50/76 mm	X50		Yes	8272
76/76 mm	X76		No	3237

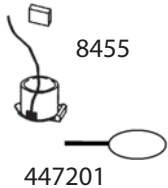

### Flap Valves with micro-switch and attached lead

Part No 8455

Flap valve 50/76 (X50 connection) with micro-switch c/w 3 m lead and terminal box.

Part No 447201

Handle to upper valve.

## Installation Examples

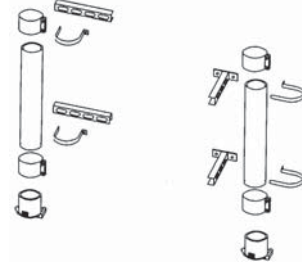

Wall outlets are available with two finishes; peened aluminum or white enamel.

## Wall Outlets

For removable connection of the suction hose. The suction hose must be equipped with a connecting sleeve. Installed in the wall with an installation kit, these provide a finished, flush mounted outlet valve. The valve body with spring loaded flap is installed after the wall is finished. On systems with on demand start-stop, the wall outlet should be equipped with a micro-switch. This will give a start-stop signal for vacuum producer control.

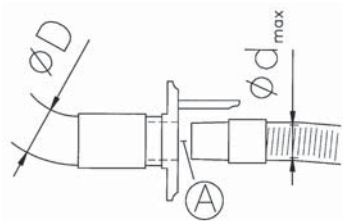

$d_{max}/D$	A	Control	Finish	Part No
38/50 mm	X38	---	peened aluminum	3230
38/50 mm	X38	micro-switch	peened aluminum	8439
38/50 mm	X38	---	white enamel	3231
38/50 mm	X38	micro-switch	white enamel	8453

## Accessories

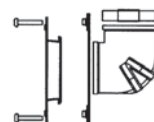

Part No 3218 Installation set with 90° joint

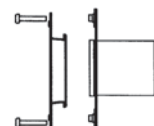

Part No 3219 Installation set with straight joint

### Dimensions, Installation

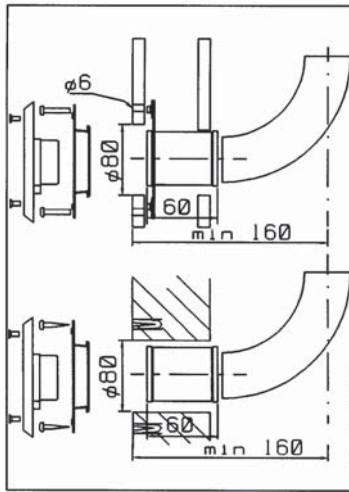
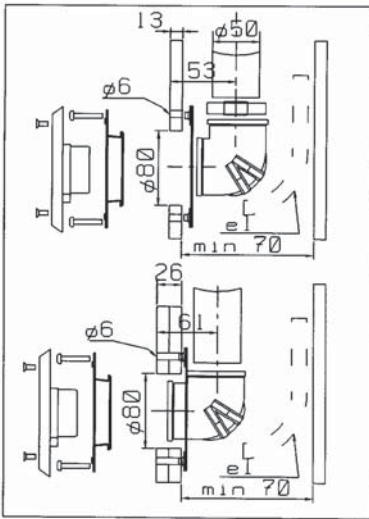

## Clean Room Wall and Floor Outlet

The outlet can be used in "clean room environments". For removable connection of the suction hose. The spring loaded cover is flush with the floor and can be opened with a special tool, see below.

The floor outlet's connection to the tubing system is a standard NPT 2 1/2" / 3" thread. Connection is prepared then screwed in when the floor covering is installed.

The floor valves must be installed so that the tubing system carries the stress or so that the valve's body (A) is installed on a level sub-surface.

Floor outlets can be specially ordered with micro-switches.

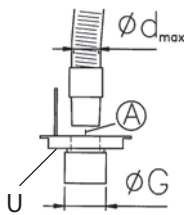

$d_{max}/G$	A	Cover	Part No
50mm/G21/2	X50	stainless steel	3239
76mm/G3	X76	stainless steel	3238



Floor outlets are available with stainless steel or brass covers.

### Accessories

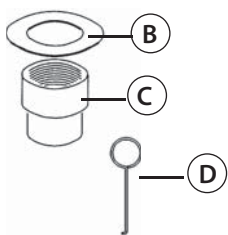

Valve dim.	Part No		
	(B)	(C)	(D)
G21/2	40378	7443+7428	40201
G3	40377	7442+7428	40201

TECHNICAL DATA	Part No	Max point load	Max total load
	3238	180 kg	360 kg
	3239	180 kg	360 kg

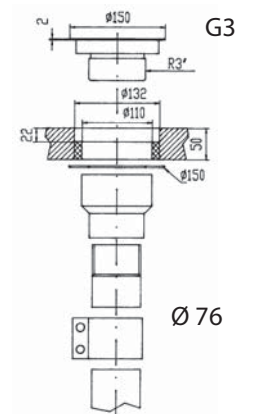
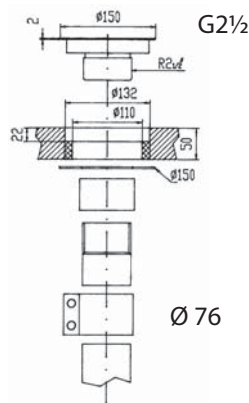

# Wall and Floor Outlet , Clean Room X38/50

The wall and floor outlet is designed to meet the requirement for clean room application. The valve body is antistatic and made of pre-stressed polypropylene. The exposed surfaces of the valve are brushed stainless steel.

The outlet is made for both wall and floor mounting.

Cover wall mounting plate and spring replacement are possible without removing and replacing the valve body.

Low profile for mounting even in thin wall partitions.

Outlet optionally equipped with inductive sensor for auto start - stop.

Select cleaning accessories Ø 32 or 38 mm.

Part No **322501**

Part No **84059** with sensor

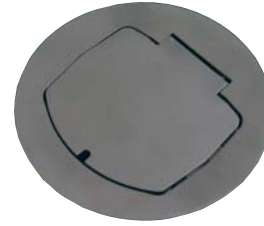

Accessories	Description	Part No
	Wall mounting plate	42254
	Joint 90°	2043
	Straight joint	2044
	Anchor plate	42264
	Connector cleanroom 38 outlet	42292
	O-ring 49,5 * 3 shore 50 nitril	40451

Wall mounting plate	42254
Joint 90°	2043
Straight joint	2044
Anchor plate	42264
Connector cleanroom outlet 38	42292
O-ring 49,5 * 3 shore 50 nitril	40451

## Anchor plate

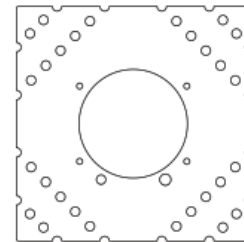

## Wall mounting

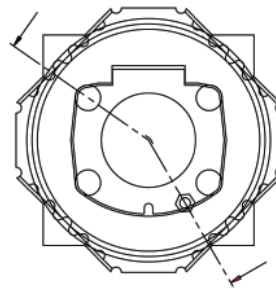
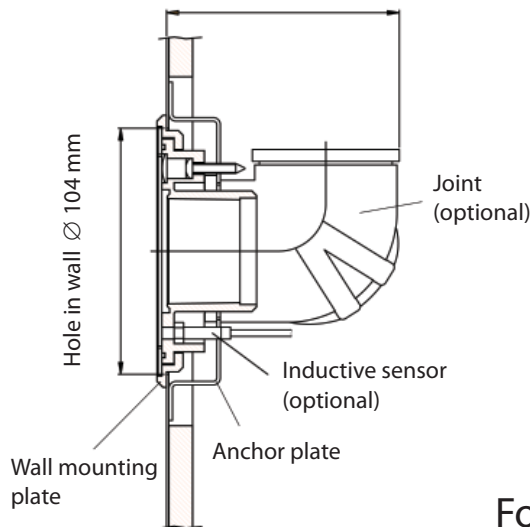

## For wooden and raised floors

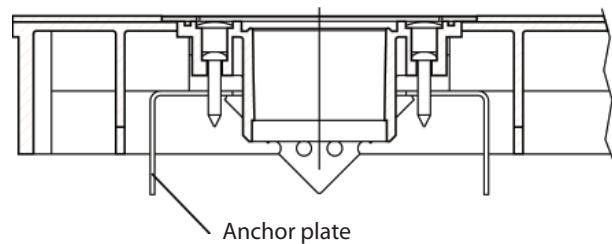

## For poured concrete floor

