

## Standard Suction Hoses

The hose is the conveying line of the source extraction installation. The demands placed on the suction hose are:

- wear resistance
- low weight and flexibility
- not affected by extremes of temperatures
- crushproof
- does not give static electric shocks

When long suction hoses have to be used their diameter should progressively increase from the suction casing, with the smallest hose nearest the suction casing not exceeding 2–3 m length. Coupling is carried out with external couplings which are easy to use.

Suction hoses, standard, Ø (in/mm)	Part no/m	Standard length
3"/76	2001	30'/10 m
2"/50	2401	15', 30', 50'/5, 10, 15 m
1.5"/38	2111	15', 30', 50'/5, 10, 15 m
1.25"/32	2112	15', 30', 50'/5, 10, 15 m
1"/25	2113	15', 30', 50'/5, 10, 15 m

Suction hoses, heat resistant, Ø (in/mm)	Part no/m	Standard length
2"/50	2004	15', 30', 50'/5, 10, 15 m
1.5"/38	2003	15', 30', 50'/5, 10, 15 m

For larger dimensions, contact us.

## Material properties

Description	Dimension Ø (in/mm)	Part No	Colour	Material	Temp °F max/min/ Temp °C max/min	Antistatic	Abrasion resistance	UV and zone resistance	Resistance to Welding Fume	Resistance to solvent and oil
Suction hoses standard	3"/76 mm	2001	Blue	PE	113/-49/+45/-45	No	2	2	3	3
	2"/50 mm	2401	Blue	PE	113/-49/+45/-45	No	2	2	3	3
	1.5"/38 mm	2111	Blue	PE	113/-49/+45/-45	No	2	2	3	3
	1.25"/32 mm	2112	Blue	PE	113/-49/+45/-45	No	2	2	3	3
	1"/25 mm	2113	Blue	PE	113/-49/+45/-45	No	2	2	3	3
Suction hoses heat resistant	2"/50 mm	2004	Grey	PP(EPDM)	194/-40/+90/-40	No	3	2	1	4
	1.5"/38 mm	2003	Grey	PP(EPDM)	194/-40/+90/-40	No	3	2	1	4
Suction hoses antistatic	3"/76 mm	2024	Black	PE	113/-40/+45/-40	Yes	2	2	3	3
	2"/50 mm	2013	Black	PE	113/-40/+45/-40	Yes	2	2	3	3
	1.5"/38 mm	2012	Black	PE	113/-40/+45/-40	Yes	2	2	3	3
	1.25"/32 mm	2005	Black	PE	113/-40/+45/-40	Yes	2	2	3	3
	1"/25 mm	2025	Black	PE	113/-40/+45/-40	Yes	2	2	3	3
Suction hoses PU	3"/76 mm	2056	Trans-	PU	194/-40/+90/-40	Yes**	1	1	3	1
	2"/50 mm	2054	parent	PU	248/-40/+120/-40	Yes**	1	1	3	1
	1.5"/38 mm	2055		PU	194/-40/+90/-40	Yes**	1	1	3	1
Super D superelastic	2"/50 mm	2039	black/white	PVC	185/-23/+85/-5	No				
	1.5"/38 mm	2038	black/white	PVC	185/-23/+85/-5	No				

Scale: 1 Excellent  
2 Good  
3 Limited  
4 Poor

Antistatic is defined as having a conductivity of <math>10^6 \Omega</math>

To order antistatic certification (ESD) according to Swedish National Testing and Research Institute (SP) – note an E after the part no.

\*\* The wire helix must be bared and left in contact with conductive material for static discharge.

Ø designates the inside of the hose

## Metal Hose

Ø (in/mm)	Part No	Temp °F max /Temp °C max	Material
2"/50	2150	Flexible 572/+300	Steel
2"/50	2151	Rigid 572/+300	Steel
1.5"/38	2138	Flexible 572/+300	Steel
1.5"/38	2139	Rigid 572/+300	Steel

## Compressed Air Hose

Diameter	Description	Part No
Ø <sub>in</sub> 3/4"	Compressed air hose 3/4	2124
Ø <sub>in</sub> 1/2"	Compressed air hose 1/2	2123
Ø <sub>in</sub> 3/8"	Compressed air hose 3/8	2122
Ø <sub>out</sub> 5 mm	Compressed air hose 5	2406
Ø <sub>out</sub> 6 mm	Compressed air hose 6	8482
Ø <sub>out</sub> 8 mm	Compressed air hose 8	8183

## Ventilation Hose

Diameter (in/mm)	Description	Part No
Ø 5"/125	Ventilation hose 4.9"/125	2420
Ø 10"/250	Ventilation hose 10"/250	2032

## Hose Clamps

Description	d <sub>min</sub> d <sub>max</sub>	Part No
Hose clamp	.3"-.6"/8-14 mm	4027
Hose clamp	.4"-.7"/11-17 mm	4028
Hose clamp	.6"-.9"/15-24 mm	4146
Hose clamp	1"-1.5"/26-38 mm	4197
Hose clamp	1.7"-2.2"/44-56 mm	4075
Hose clamp	2"-2.6"/50-65 mm	4219
Hose clamp	2.3"-3"/58-75 mm	4002
Hose clamp	2.7"-3.3"/68-85 mm	3002
Hose clamp	3"-3.7"/77-95 mm	4090
Hose clamp	3.4"-4.4"/87-112 mm	4310
Hose clamp	4.1"-5.4"/104-138 mm	4138
Hose clamp	5.1"-6.5"/130-165 mm	4040
Hose clamp	5.9"-7.1"/150-180 mm	4137
Hose clamp	7.9"-9.1"/200-231 mm	4464
Hose clamp	8.9"-10.1"/226-256 mm	4102



# Rubber Suction Hose

Ø (in/mm)	Part No Standard	Part No Extra Abrasion Resistant
6"/152	2010	2045
4"/102	2011	2042
3"/76	See PU-suction hose	2046

## TECHNICAL DATA

Part No	2010	2011	2033	2046	2045
Material gauge (in/mm)	06"/1.6	06"/1.6	5.0	.16"/4.0	.24"/6.0
Minradius (in/mm)	7.9"/200	5.9"/150	400	4.9"/125	23.6"/600
Weight (lbs/yd /kg/m)	4.2/1.9	2.6/1.2	2.9	3.1/1.4	10.6/4.8
Temp max (°F /°C)	194 /+90	194 /+90	+70	194 /+90	194 /+90
min (°F /°C)	-40	-40	-35	-40	-22/-30
Internal tube	antistatic rubber	antistatic rubber	antistatic rubber	antistatic wear rubber	antistatic wear rubber
Insert	steel helix	steel helix	steel helix	steel helix copper wire	steel helix copper wire
External tube	antistatic rubber	antistatic rubber	synthetic rubber (2033 weatherproof wear rubber)	weatherproof antistatic wear rubber	weatherproof antistatic wear rubber

## Hose Hanger

Description	Part No
-------------	---------

- Hose Hanger, white enamel 4473
- Hose Hanger, stainless 7214

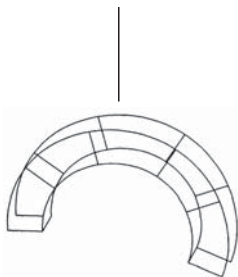

Ø designates the inside of the hose

## Couplings for Rubber Suction Hose/ Extra Abrasion Resistant

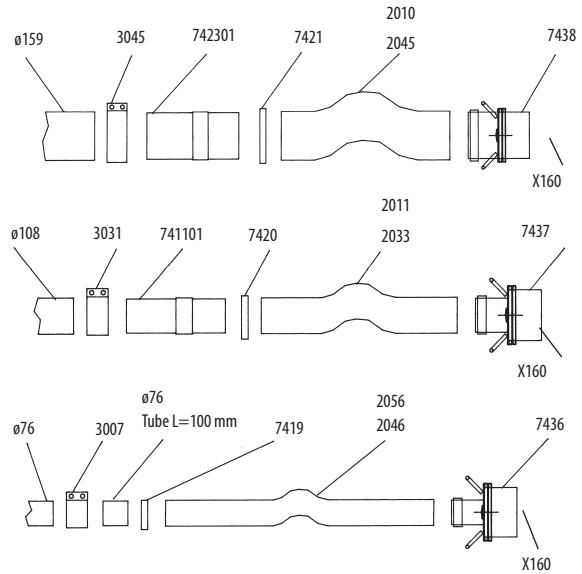

Part No	Description
---------	-------------

- 3007 Joint Ø 3"/76
- 3031 Joint Ø 4.3"/108
- 3045 Joint Ø 6.3"/160
- 741101 Pipe connection 4.3"/4"/108/102
- 7419 Hose clamp 3"/76
- 7420 Hose clamp 4"/102
- 7421 Hose clamp 6.3"/160
- 742301 Pipe connection 6.3"/6"/159/152
- 7436 Hose connector 3"/X6.3"/76/X160
- 7437 Hose connector 4"/X6.3"/102/X160
- 7438 Hose connector 6"/X6.3"/152/X160

## Pressure Loss Suction Hoses

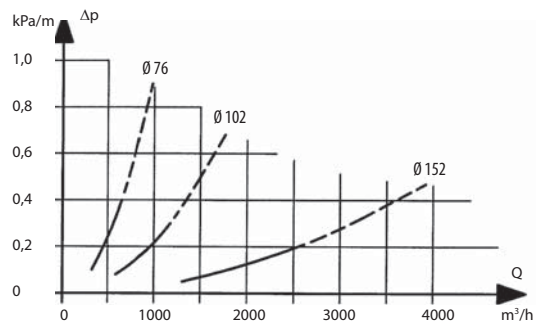
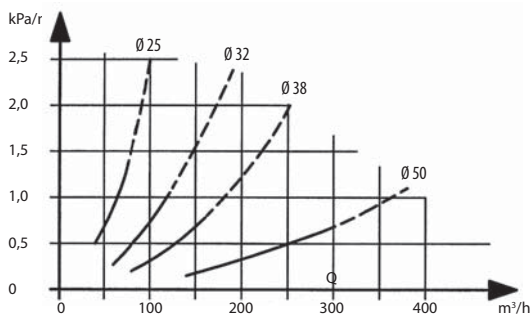



## Turnable Connectors for Suction Hose; PU

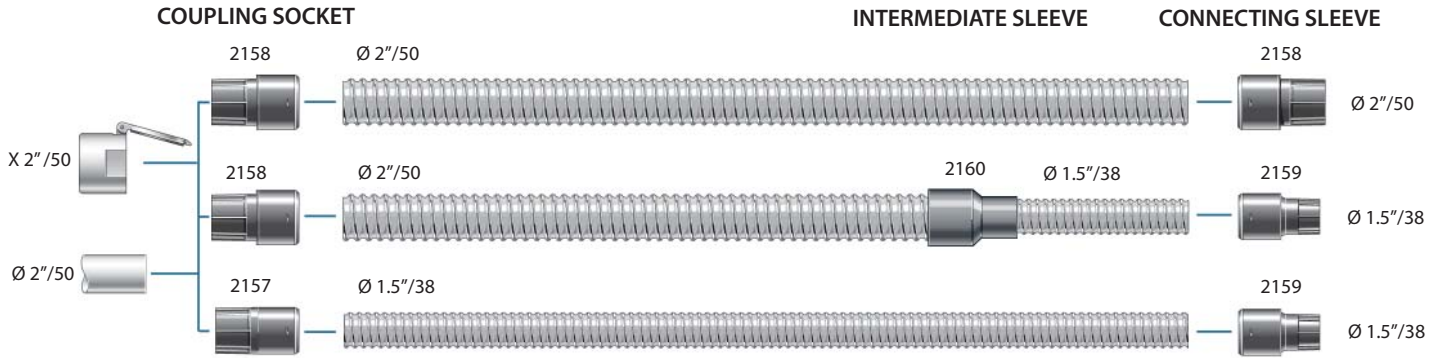

## Non-Turnable Connectors for Suction Hose; PU

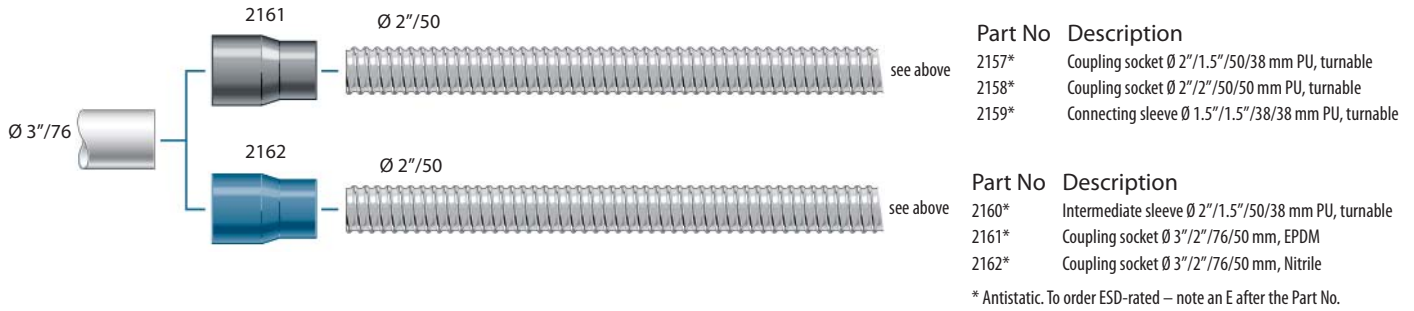

## Extraction Hose Quick Couplers

Part No 2166

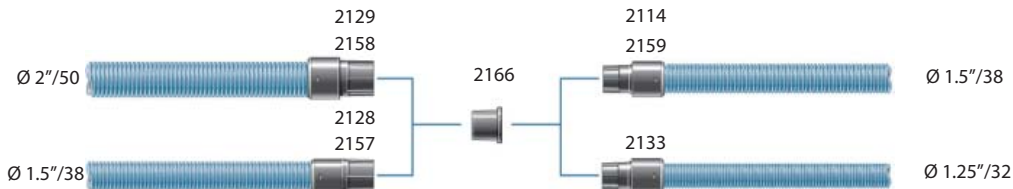

## Multi Connection for Integrated Suction Casings

Part No 42497

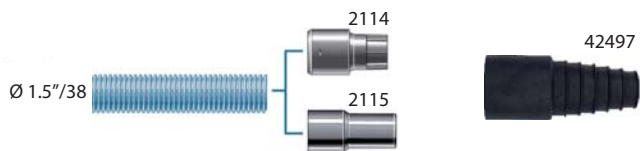

Part No	Description
42497*	Multi connection for integrated suction casings
2114*	Connecting sleeve, turnable 38/38
2115*	Connecting sleeve 38/38

\*Antistatic EPDM

The multi connection fits onto suction casings with outlet diameter 25-35 mm. Cut off a section at the right diameter (it's marked in advance with: 25,27,29,31,33,35 mm) and push on to the multi connection over the tubing of integrated suction casings. Connection sleeves 2114 or 2115 then fit to the other end to link the hose.

# Hose Sets

Part No	Description
2125	Hose set 2"/1.5"/50/38 mm L = 21'7 m
2126	Hose set 2"/1.5"/50/38 mm L = 15'5 m antistatic
2006	Hose set 1.5"/38 mm L = 6'2 m
2015	Hose set 1.5"/38 L = 6'2 m
2105	Hose set 1.5"/38 L = 15'5 m*

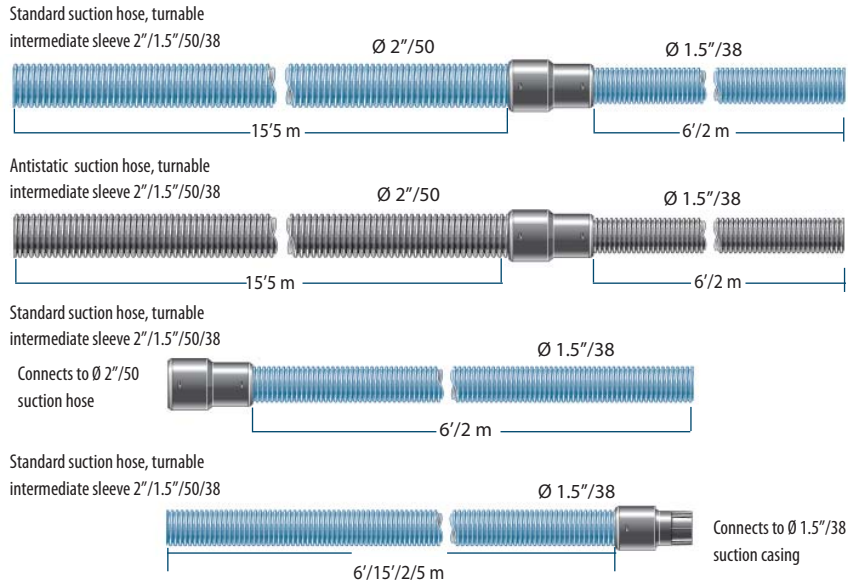

\* Standard suction hose, turnable, non removable connector. (Replacement to standard hose kit.)

# Technical Data on Extraction Hose Fittings

Description	Dimension Ø (in/mm)	Part No	Colour	Material	Temp °F max/min/ Temp °C max/min	Antistatic	Abrasion resistance	UV and zone resistance	Resistance to Welding Fume	Resistance to solvent and oil
Coupling socket	3"/2"/76/50	2008*	Black	EPDM	284/-76/140/-60	Yes	2	1	2	4
	2"/2"/50/50	2107*	Black	EPDM	284/-76/140/-60	Yes	2	1	2	4
	2"/1.5"/50/38	2108*	Black	EPDM	284/-76/140/-60	Yes	2	1	2	4
	3"/2"/76/50 (PU)**	2161*	Black	EPDM	284/-76/140/-60	Yes	2	1	2	4
Coupling socket	3"/2"/76/50	2162*	Blue	NBR	248/-76/120/-60	Yes	2	3	3	2
Coupling socket	2"/2"/50/50	2129*	Black	PA12	284/-4/140/-20	Yes	1	2	3	1
	2"/2"/50/50 (PU)**	2158*	Black	PA12	284/-4/140/-20	Yes	1	2	3	1
	2"/1.5"/50/38 (PU)**	2157*	Black	PA12	284/-4/140/-20	Yes	1	2	3	1
	2"/1.5"/50/38	2128*	Black	PA12	284/-4/140/-20	Yes	1	2	3	1
	1.5"/1.25"/38/32	2133*	Black	PA12	284/-4/140/-20	Yes	1	2	3	1
Connecting sleeve	1.25"/1.5"/32/38	2132*	Black	PA12	284/-4/140/-20	Yes	1	2	3	1
	1.5"/1.5"/38/38 (PU)**	2159*	Black	PA12	284/-4/140/-20	Yes	1	2	3	1
	1.5"/1.5"/38/38	2114*	Black	PA12	284/-4/140/-20	Yes	1	2	3	1
	2"/2"/50/50	2129*	Black	PA12	284/-4/140/-20	Yes	1	2	3	1
	1"/1"/25/25	2167*	Black	PA12	284/-4/140/-20	Yes	1	2	3	1
Connecting sleeve	1.5"/1.5"/38/38	2115*	Black	PA12	284/-4/140/-20	Yes	1	2	3	1
	1"/1.5"/26/38	2109*	Black	EPDM	284/-76/140/-60	Yes	2	1	2	4
	1"/1.25"/26/32	2110*	Black	EPDM	284/-76/140/-60	Yes	2	1	2	4
	.7"/1.25"/17/32	2106*	Black	EPDM	284/-76/140/-60	Yes	2	1	2	4
Connecting sleeve	1.25"/1.25"/32/32	2116	Grey	PE	45/-45	No	1	2	3	1
	1"/1"/25/25	2117	Grey	PE	45/-45	No	1	2	3	1
	2"/1.5"/50/38	2131*	Black	PA12	284/-4/140/-20	Yes	1	2	3	1
Inter, sleeves	2"/1.5"/50/38 (PU)**	2160*	Black	PA12	284/-4/140/-20	Yes	1	2	3	1
	3"/2"/76/50	2100*	Black	EPDM	284/-76/140/-60	Yes	2	1	2	4
	2"/1.5"/50/38	2120*	Black	EPDM	284/-76/140/-60	Yes	2	1	2	4
	1.5"/1.25"/38/32	2121*	Black	EPDM	284/-76/140/-60	Yes	2	1	2	4
Hose connector	1.25"/1"/32/25	2101*	Black	EPDM	284/-76/140/-60	Yes	2	1	2	4
	2"/50	2403	Grey	PE	45/-45	No	2	2	3	3
	1.5"/38	2118	Grey	PE	45/-45	No	2	2	3	3
Hose connector	1.25"/32	2119	Grey	PE	45/-45	No	2	2	3	3
	2"/50	2170*	Black	PA12	284/-4/140/-20	Yes	1	2	3	1
	1.5"/38	2169*	Black	PA12	284/-4/140/-20	Yes	1	2	3	1
	1.25"/32	2168*	Black	PA12	284/-4/140/-20	Yes	1	2	3	1

Scale: 1 Excellent 2 Good  
3 Limited 4 Poor

\*Antistatic is defined as having a conductivity of < 10<sup>6</sup> Ω

To order Antistatic certification (ESD-rated) – note an E after the part no. Tested according to Swedish National Testing and Research Institute (SP).

\*\* Static conductivity can be compromised by excessive hose wear.

## About Cleaning Accessories

For the best results when cleaning, it is necessary to have the right equipment and to use it in the correct way. It is therefore a prerequisite that a variety of different accessories are available for different tasks. 1.25"/32 mm cleaning accessories are recommended when very light tools are required e.g.: office cleaning. 1.5"/38 mm cleaning tools are ideal in most cases, they combine good capacity with ease of handling. Everything is available, from light tools such as wands in aluminium and tools in plastic and rubber to sturdy wear resistant wands in steel and cast aluminium floor tools. 2"/50 mm cleaning accessories are used for very heavy cleaning. Aluminium wands, large wheels on the floor tools and the ERGO-grip are several of the details which allow the accessories to be used easily despite their size. 3"/76 mm accessories are used for different types of material transport.

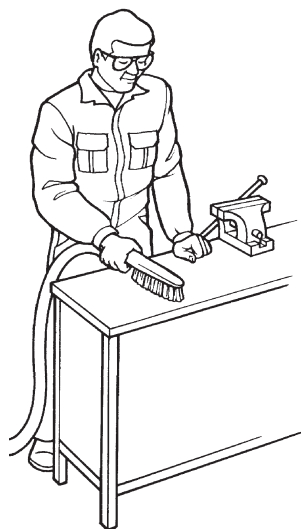

## Cleaning Accessories Ø 1.25"/32 mm



7293



7294



7358



7292

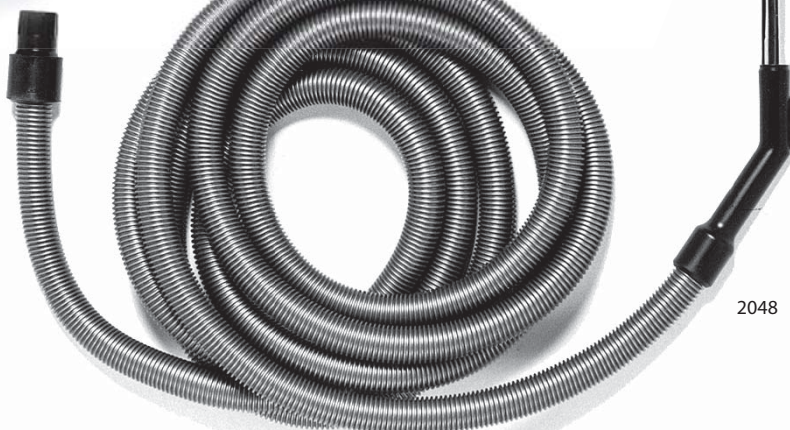

2048

### Part No Description

2048	Hose set L=24'/8 m w hand pipe
7292	Suction brush 1.25"/32 mm
7293	Floor Tool 10.5/270 mm P-1.25"/32 mm
7294	Chromed Wand 1.25"/32 mm telescopic
7358	Suction brush 1.25"/32 mm, antistatic

### TECHNICAL DATA

$Q_{nom}$	90 cfm/150 m <sup>3</sup> /h
$\Delta p_{nom}$	28 inwg/7 kPa

# Cleaning Accessories Ø 1.5"/38 mm



**Part No Description**

7035	Chrome Steel hand pipe Ø 1.5"/38 mm, straight
7038	Suction Nozzle Ø 1.5"/38 mm
7047	Suction Brush B 8"/200 mm
7048	Pipe Nozzle RB 4"/100 mm
7049	Pipe Nozzle RB 8"/200 mm
7154	Brush for pipe nozzle 7048
7213	Chrome Steel Flat Nozzle Ø 1.5"/38 mm L= 16"/400 mm
7235*	Cast Alu Floor Tool B 15"/370 mm Ø 1.5"/38 mm
7236*	Cast Alu Floor Tool B 18"/450 Ø 1.5"/38 mm
7257*	Chrome Steel Wand Ø 1.5"/38 mm
7258*	SLightweight Alu Wand Ø 1.5"/38 mm
7259*	Lightwiegth Alu Wand Ø 1.5"/38 mm, with wear strip
7260	Chrome Steel Wand Extension Ø 1.5"/38 mm, L = 715 mm
7261*	Alu Wand Extension Ø 1.5"/38 mm, L = 705 mm
7262	Chrome Steel hand pipe Ø 1.5"/38 mm curved
7263	Brush for 7275, 7278
7264*	Tapered nozzle Ø 1.5"/38 mm
7275	Rubber part of suction brush Ø 1.5"/38 mm, 7278
7276*	Tapered nozzle Ø 1.5"/38 mm
7278	Suction brush Ø 1.5"/38 mm
7291	Flat nozzle Ø 1.5"/38 mm L= 14"/350 mm plastic
7297	Crevice nozzle Ø 1.5"/38 mm, B= 8"/200 mm
7300	Rubber floor tool Ø 1.5"/38 mm
7320	Molded Plastic Floor Tool 12.5"/320 mm Ø 1.5"/38 mm, with rubber wiper
7321	Molded Plastic Floor Tool 12.5"/320 mm Ø 1.5"/38 mm, with brush
7322	Molded Plastic Floor Tool 12.5"/370 mm Ø 1.5"/38 mm, with rubber wiper
7323	Molded Plastic Floor Tool 12.5"/370 mm Ø, 1.5"/38 mm, with brush
7365	Flat nozzle Ø 1.5"/38 mm L= 14"/350 mm, Antistatic
7374	Brush ESD for 7278E, 7279E
7376	Push-Pull Pistol
7398	Brush for 7278, 7279, hard, white



**TECHNICAL DATA**

Floor nozzle;	
Light applications	
Q <sub>nom</sub>	120 cfm/200 m <sup>3</sup> /h
Δp <sub>nom</sub>	20 inwg/5 kPa
Heavy applications	
Q <sub>nom</sub>	150 cfm/250 m <sup>3</sup> /h
Δp <sub>nom</sub>	32 inwg/8 kPa
Hand Nozzle;	
Q <sub>nom</sub>	150 cfm/250 m <sup>3</sup> /h
Δp <sub>nom</sub>	12 inwg/3 kPa

\* Antistatic. To order ESD-rated – note an E after the Part No.

# Cleaning Accessories Ø 2"/50 mm



## Part No Description

7013	Rubber part, floor tool Ø 2"/50 mm
7016	Suction nozzle with brush
7026	Saw blade
7030	Suction nozzle Ø 2"/50 mm
7033	Chrome Steel Hand pipe Ø 2"/50 mm
7149	Chip nozzle D 50 W 70 L 243
7212	Chrome Stell Flat tool Ø 2"/50 mm L=16"/400 mm
7238*	Cast Alu Floor Tool B 20"/500 mm A--2"/50 mm
7263	Brush for 7274, 7279
7265	Chrome Steel Wand Ø 2"/50 mm
7266	Alu Lightweight Wand Ø 2"/50
7267	Alu Lightweight Wand Ø 2"/50 mm, wear st
7268	Chrome Steel Wand ext Ø 2"/50 mm, L = 710 mm
7269	Alu Wand Extension Ø 2"/50 mm, L = 685 mm
7271	Chrome Steel hand pipe Ø 2"/50 mm curved
7272	Tapered nozzle Ø 2"/50 mm
7274	Rubber part, suction brush Ø 2"/50 mm
7277*	Tapered nozzle Ø 2"/50 mm
7279	Suction brush Ø 2"/50 mm
7281	Floor nozzle Ø 2"/50 mm B 8"/200 mm
7285	Handle ERGO-Grip
7295	Bulk nozzle Ø 2"/50 mm
7307	Gulper Floor Tool Alu
7374	Brush ESD for 7278E, 7279E
7377	Push Pull Pistol
7398	Brush for 7278, 7279, hard, white



## TECHNICAL DATA

### Floor nozzle;

$Q_{nom}$	210 cfm/350 m <sup>3</sup> /h
$\Delta p_{nom}$	32 inwg/8 kPa

### Hand Nozzle;

$Q_{nom}$	210 cfm/350 m <sup>3</sup> /h
$\Delta p_{nom}$	12 inwg/3 kPa

\* Antistatic. To order ESD-rated – put an E after the Part No.

## Cleaning Accessories Ø 3"/76 mm

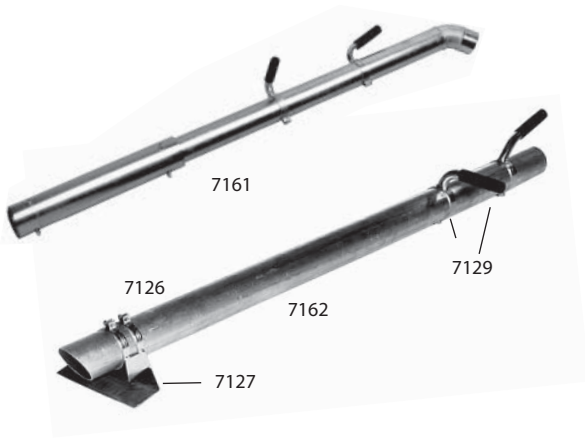

Part No	Description
7126	Clamp for scraper
7127	Scraper for suction lance
7129	Handle complete
7161	Bulk nozzle Ø 3"/76
7162	Suction lance Ø 3"/76

# Spare Parts for Floor Tools

## Molded Plastic Floor Tools Ø1.5"/38 mm

Set	B = 12.6" / 320 mm		B = 14.6" / 370 mm	
	7320	7321	7322	7323
A Rubber band B 316/288 (2 pcs)	7328	x -	7329	x -
B Front brush	7225	- x	7226	- x
C Rear brush	7326	- x	7327	- x
D Brush holder	7215	x x	7216	x x
E Brush holder	7324	x x	7325	x x
F Wheel, floor nozzle P	40455	x x	40455	x x

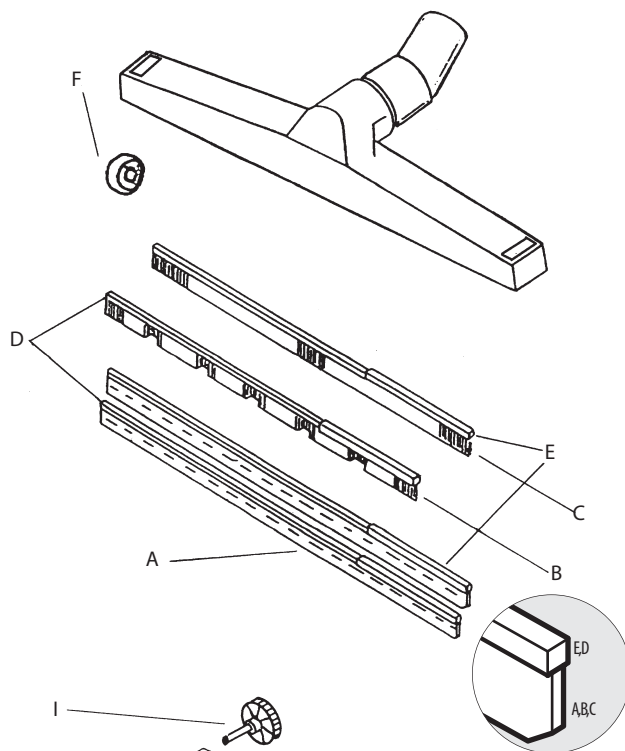

## Cast Alu Floor Tools Ø1.5"/38 mm, Ø2"/50 mm

Set	Ø 1.5" / 38 mm		Ø 2" / 50 mm	
	B = 14.6" / 370 mm	B = 17.7" / 450 mm	B = 19.7" / 500 mm	
	7235	7236	7238	
A Rubber band* (2 pcs)	7045	x 7014	x 7051	x
B Front brush	7222	- 7223	- 7224	-
C Rear brush	7225	- 7228	- 7227	-
D Brush holder	7216	x 7218	x 7219	x
E Brush holder	7215	x 7217	x 7218	x
F Cover 370 A	7242	x 7243	x 7244	x
G Wheel, floor nozzle A	7252	x 7252	x 7252	x
H Clamp	7239	x 7240	x 7241	x
I Adjusting screw	7253	x 7253	x 7253	x
J Coned connection 38, antistatic	7335	x 7335	x 7245	x

\* Also by the metre, Part No 7058 (50 m)

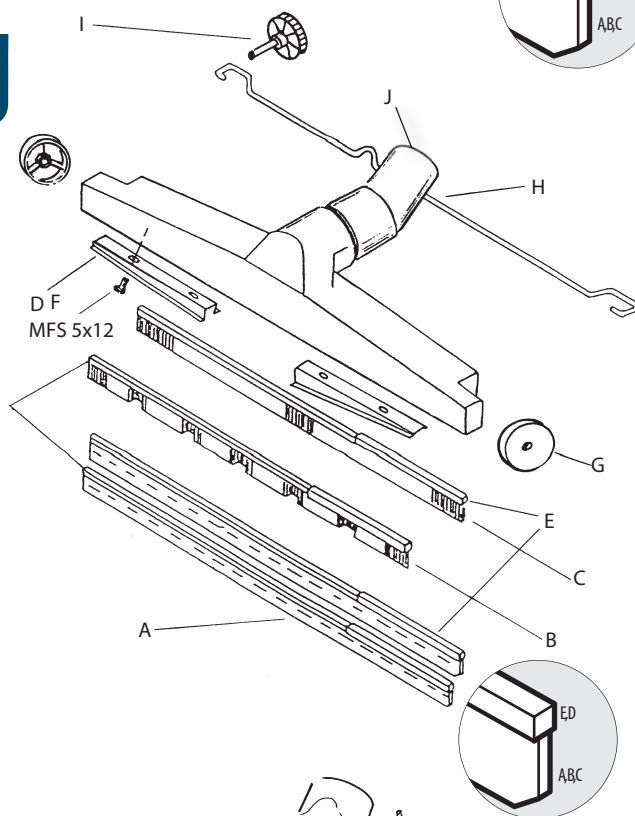

## Gulper Floor Tool Ø2"/50 mm, Alu

Set	B = 15.7" / 400 mm		B = 17.7" / 450 mm	
	7108		7115	7116
Rubber moulding (2 pcs)	7108	x		
Brush B 450/420	7046	x		
Brush holding moulding	7115	x		
Brush holding moulding	7116	x		
Wheel kit	7146	x		

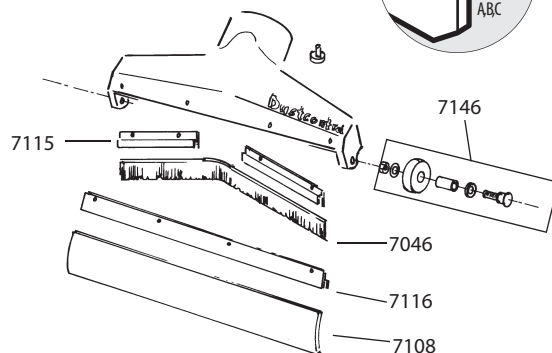

x = standard  
- = can be changed



## Filters

### Cellulose Fine Filter

Good quality standard filter with high filtration efficiency. Epoxy treated for resistance to humidity and other elements.

### Polyester Fine Filter

High quality filter material with exceptional resistance to most elements. Particularly suitable to high humidity applications such as machine and tool shops where cutting and cooling fluids are used. Filter can be washed.

### HEPA Filter

The HEPA filter is made of fibreglass material with a support layer of cellulose. Filtration efficiency is 99.995% EN 60335.

Note: When changing filters the gasket of the filter holder has to be checked and cleaned. Leakage is not permitted in Asbestos applications.

**In applications requiring special filter materials, standard filter configurations can be ordered with alternative materials.**



#### DC 1800, DC 2800c, DC 2800c Rental, DC 2800a

Part No	Description	Construction	Material	Area (ft <sup>2</sup> /m <sup>2</sup> )	Classification	Max temp (°F/°C)
42029	Fine filter	Pleated around support cyl.	Cellulose, epoxy treated	16.2/1.5	IEC EN 60335-2-69 Part 1	176/80
42029ST	Fine filter, 48 pcs		Cellulose			
42028	Fine filter	Pleated	Polyester	16.2/1.5	IEC EN 60335-2-69 Part 1	266/130
42027	HEPA filter	Pleated	Cellulose, fibreglass	9.2/0.85	HEPA H13	176/80
40479	Combi-filter (Fine filter + HEPA filter), (GS Asbestos)	Pleated	Cellulose, epoxy treated	16.2/1.5	HEPA H13	176/80

#### DC 3800a, DC 3800c, DC 3800c Turbo, DC 3800c Twin, DC 3800TR S, DC 3800i, DC 3800 Stationary

Part No	Description	Construction	Material	Area (ft <sup>2</sup> /m <sup>2</sup> )	Classification	Max temp (°F/°C)
42026	Fine filter	Pleated around support cyl.	Cellulose, epoxy treated	19.5/1.8	IEC EN 60335-2-69 Part 1	176/80
42026ST	Fine filter, 24 pcs		Cellulose			
42025	Fine filter	Pleated	Polyester	19.5/1.8	IEC EN 60335-2-69 Part 1	266/130
42025ST	Fine filter, 24 pcs		Polyester			
42465	Fine filter PTFE	Pleated around support cyl.	Polyester PTFE	19.5/1.8	IEC EN 60335-2-69 Part 1	266/130
42024	HEPA filter	Pleated	Cellulose, fibreglass	16.2/1.5	HEPA H13	176/80

#### DC 5800c 9.2 kW P, DC 5800a/c PTFE, DC 5800i, S 11000, S 21000, S 32000, S 34000, DC 11-Module

Part No	Description	Construction	Material	Area (ft <sup>2</sup> /m <sup>2</sup> )	Classification	Max temp (°F/°C)
429203	Fine filter PTFE	Pleated around support cyl.	Polyester PTFE	53.8/50	IEC EN 60335-2-69 Part 1	266/130
4292	Fine filter	Pleated around support cyl.	Polyester	90.4/8.4	IEC EN 60335-2-69 Part 1	266/130
4422	HEPA filter, DC 5800 5 kW, 9.2 kW S, TR (installed under top cover)	Pleated around support cyl.	Cellulose, fibreglass	26.9/2.5	HEPA H13	176/80
4284	Fine filter S 3400X C-class	Pleated around support cyl.	Polyester	129.6/12	IEC EN 60335-2-69 Part 1	266/130
4017	HEPA filter, DC 5800c 9.2 kW P (2 pcs/machine) (installed on exhaust)	Pleated	Cellulose, fibreglass	26.9/2.8	HEPA H13	176/80

#### DC 5800a, DC 5800c 5 kW, DC 5800c 9.2 kW S, DC 5800 TR

Part No	Description	Construction	Material	Area (ft <sup>2</sup> /m <sup>2</sup> )	Classification	Max temp (°F/°C)
429204	Fine filter	Pleated around support cyl	Polyester	53.8/50	IEC EN 60335-2-69 Part 1	266/130
4422	HEPA filter	Pleated around support cyl	Cellulose, fibreglass	26.9/2.5	HEPA H13	176/80

#### Air Cleaners: DC AirCube/DC AirCube Rental/DC AirCube X2/DC AirCube 2000

Part No	Description	Construction	Material	Area (ft <sup>2</sup> /m <sup>2</sup> )	Classification	Max temp (°F/°C)
4080	Pre-filter	Carpet, single ply	Polyester	1.08/0.1	IEC EN 60335-2-69 Part 1	212/100
42136	Combi-filter (Fine filter + HEPA filter)	Cartridge, pleated	Fibreglass	56.1/5.2	HEPA H13	176/80
42618	HEPA filter	Pleated around support	Cellulose, fibreglass	87.8/8.16	HEPA H13	122/50
42619	Pre-filter	Carpet	Non-woven Polyester	6.4/0.6	G4	122/50

## Filters for Earlier models

### DC 2500i, DC 2500, DC 2500 Twin

Part No	Description	Construction	Material	Area (ft <sup>2</sup> /m <sup>2</sup> )	Classification	Max temp (°F/°C)
4889	Fine filter	Pleated	Polyester	15.1/1.4	IEC EN 60335-2-69 Part 1	266/130
404901	Fine filter	Pleated around support cyl.	Cellulosa	16.2/1.5	IEC EN 60335-2-69 Part 1	158/70
4821	HEPA filter K	Pleated	Cellulose, fibreglass	16.2/1.5	HEPA H13	158/70
4133	HEPA filter (installed in the fine filter)	Pleated around support cyl.	Cellulose, fibreglass	5.4/0.5	HEPA H13	176/80

DC 2700c, DC 2700i From serial number 2527595, the DC 2700c and the DC 2700i can be equipped with a separate HEPA-filter (Part No. 42027). Older models shall be equipped with a single HEPA combifilter.

Part No	Description	Construction	Material	Area (ft <sup>2</sup> /m <sup>2</sup> )	Classification	Max temp (°F/°C)
42029	Fine filter	Pleated around support cyl.	Cellulose, epoxy treated	16.2/1.5	IEC EN 60335-2-69 Part 1	176/80
42029ST	Fine filter, 48 pcs		Cellulose			
42028	Fine filter	Pleated	Polyester	16.2/1.5	IEC EN 60335-2-69 Part 1	266/130
40479	Combi-filter (Fine filter + HEPA filter)	Pleated	Cellulose, fibreglass , epoxy treated	16.2/1.5	HEPA H13	176/80

### DC 3500, DC 3500 TR, DC 3500 Stationary, DC 5500, DC 5500i

Part No	Description	Construction	Material	Area (ft <sup>2</sup> /m <sup>2</sup> )	Classification	Max temp (°F/°C)
408801	Fine filter	Pleated	Polyester	17.2/1.6	IEC EN 60335-2-69 Part 1	266/130
408803	Fine filter	Pleated	Cellulose	17.2/1.6	IEC EN 60335-2-69 Part 1	176/80
4821	HEPA filter, DC 3500 TR	Pleated	Cellulose, fibreglass	16.2/1.5	HEPA H13	158/70
4366	HEPA filter, DC 3500 (installed on exhaust)	Pleated around support cyl.	Cellulose, fibreglass	12.9/1.2	HEPA H13	176/80
4422	HEPA filter, DC 5500 5 kW, 9,2 kW S (installed under top cover)	Pleated around support cyl.	Cellulose, fibreglass	26.9/2.5	HEPA H13	176/80
4017	HEPA filter, DC 5500 9,2 kW P (installed on exhaust)	Pleated	Cellulose, fibreglass	26.9/2.8	HEPA H13	176/80

### DC 3500i, DC 5700c

Part No	Description	Construction	Material	Area (ft <sup>2</sup> /m <sup>2</sup> )	Classification	Max temp (°F/°C)
4916	Fine filter	Pleated	Polyester	16.2/1.5	IEC EN 60335-2-69 Part 1	266/130
4917	Combi-filter DC 3500i (Fine filter + HEPA filter)	Pleated	Cellulose, fibreglass	16.2/1.5	HEPA H13	176/80
4422	HEPA filter DC 5700 5 kW, 9,2 kW S (installed under top cover)	Pleated around support cyl.	Cellulosa, fibreglass	26.9/2.5	HEPA H13	176/80
4017	HEPA filter DC 5700 9,2 kW P (installed on exhaust)	Pleated	Cellulose, fibreglass	26.9/2.8	HEPA H13	176/80

### DC 3700c

Part No	Description	Construction	Material	Area (ft <sup>2</sup> /m <sup>2</sup> )	Classification	Max temp (°F/°C)
42026	Fine filter	Pleated around support cyl.	Cellulose, epoxy treated	19.5/1.8	IEC EN 60335-2-69 Part 1	176/80
42025	Fine filter	Pleated	Polyester	19.5/1.8	IEC EN 60335-2-69 Part 1	266/130
4505	Combi-filter (Fine filter + HEPA filter)	Pleated	Cellulose, fibreglass , epoxy treated	19.5/1.8	HEPA H13	176/80

### Air Cleaners DC 380/DC 1500

Part No	Description	Construction	Material	Area (ft <sup>2</sup> /m <sup>2</sup> )	Classification	Max temp (°F/°C)
4080	Pre-filter, DC 380	Carpet, single ply	Polyester	1.08/0.1	IEC EN 60335-2-69 Part 1	212/100
4669	Pre-filter, DC 1500	Carpet, single ply	Polyester	3.2/0.3	IEC EN 60335-2-69 Part 1	212/100
4079	Combi-filter (Fine filter + HEPA filter), DC 380	Cartridge, pleated	Fibreglass	50.9/4.7	HEPA H13	248/120
4667	Combi-filter (Fine filter + HEPA filter), DC 1500	Cartridge, pleated	Fibreglass	171.7/15.9	HEPA H13	248/120

## Some of our most common filters



# Plastic Sacks

All plastic sacks are manufactured in strong LD-polyethylene.



Sacks are sold in packs of 50

Plastic sacks, model	Standard	Antistatic	Volume (gal/litre)	Size (in/mm)
<b>Single-phase dust extractors</b>				
DC 1800	42291*		4 gal/15 l	21.7" x 21.7"/550 x 550 mm
DC 2800c	4814		5 gal/20 l	17.3" x 21.7"/440 x 550 mm
DC 2800c Rental	4814		5 gal/20 l	17.3" x 21.7"/440 x 550 mm
DC 2800 H Asbestos	42285	42384	5 gal/20 l	14" x 27.5"/360 x 700 mm
DC 3800c	4314		10.5 gal/40 l	19.7" x 33.5"/500 x 850 mm
DC 3800c Twin	4314		10.5 gal/40 l	19.7" x 33.5"/500 x 850 mm
<b>Three-phase dust extractors</b>				
DC 3800c Turbo	4314		10.5 gal/40 l	19.7" x 33.5"/500 x 850 mm
DC 3800c Twin Turbo	4314		10.5 gal/40 l	19.7" x 33.5"/500 x 850 mm
DC 5800c	4614		15.5 gal/60 l	27.5" x 33.5"/700 x 850 mm
<b>Compressed air dust extractors</b>				
DC 3800 TR S	4314		10.5 gal/40 l	19.7" x 33.5"/500 x 850 mm
DC 5800 TR	4614		15.5 gal/60 l	27.5" x 33.5"/700 x 850 mm/
<b>EX-Line</b>				
DC 1800 EX				21.7" x 21.7"/550 x 550 mm
DC 2800 EX				17.3" x 21.7"/440 x 550 mm
DC 3800 EX				19.7" x 33.5"/500 x 850 mm
DC 3800 Turbo EX				19.7" x 33.5"/500 x 850 mm
DC 5800 EX				27.5" x 33.5"/700 x 850 mm
<b>Stationary dust extractors</b>				
S 11000	4614	42111	23 gal/90 l	27.5" x 33.5"/700 x 850 mm/ 27.5" x 43.3"/700 x 1100 mm
S 21000	4714	42111	23 gal/90 l	27.5" x 43.3"/700 x 1100 mm
S 32000	4714	42111	23 gal/90 l	27.5" x 43.3"/700 x 1100 mm
S 34000	4714	42111	23 gal/90 l	27.5" x 43.3"/700 x 1100 mm
S 34000X	4714	42111	23 gal/90 l	27.5" x 43.3"/700 x 1100 mm
DC 3800 Stationary	4314		10.5 gal/40 l	19.7" x 33.5"/500 x 850 mm
DC 11-Module	4614		15.5 gal/60 l	27.5" x 33.5"/700 x 850 mm
<b>Pre-separators</b>				
DCF 2800	4814		5 gal/20 l	17.3" x 21.7"/440 x 550 mm
DCF 2500	4814		5 gal/20 l	17.3" x 21.7"/440 x 550 mm
DCF 3500	4314		10.5 gal/40 l	19.7" x 33.5"/500 x 850 mm
DCF Mobil	4714	42111	23 gal/90 l	27.5" x 43.3"/700 x 1100 mm
F 8000	4714		23 gal/90 l	27.5" x 43.3"/700 x 1100 mm
F 11000	4614		23 gal/90 l	27.5" x 33.5"/700 x 850 mm/27.5" x 43.3"/700 x 1100 mm
F 20000	4714	42111	23 gal/90 l	27.5" x 43.3"/700 x 1100 mm
F 30000	4714	42111	23 gal/90 l	27.5" x 43.3"/700 x 1100 mm
<b>Old dust extractors</b>				
DC 2500	4814		5 gal/20 l	17.3" x 21.7"/440 x 550 mm
DC 2700c	4814		5 gal/20 l	17.3" x 21.7"/440 x 550 mm
DC 2500 Twin	4314		10.5 gal/40 l	19.7" x 33.5"/500 x 850 mm
DC 3500	4314		10.5 gal/40 l	19.7" x 33.5"/500 x 850 mm
DC 5500	4614		15.5 gal/60 l	27.5" x 33.5"/700 x 850 mm
DC 11000	4614		15.5 gal/60 l	27.5" x 33.5"/700 x 850 mm